

LeeSti Adjustable Trimless Wall MRI

LeeSti Adjustable Wall Recessed Trimless LED

1-Make sure electrical power has been disconnected from lighting circuit before instalation.

2-Installation should be consistent with local electrical codes, nec and ulstandards.

-Collect necessary parts and tools to install:
LeeSti Lighting Module
Fixture frame with plate brackets.
Brackets to adjust to drywall with plastic screws.
Driver Remote and whip to connect lighting module
Tools: Plier, Phillips scwdriver, Hex Key, (by others)

DO NOT CHANGE PLASTIC SCREWS FOR METALLIC SCREWS

3-Cut Out
2' module 25" x 2 7/8"
4' module 47 1/4" x 2 7/8".

4- Install drivers in desired location and wires for main power.

5-Insert fixture frame into wall opening so that flange is only showing at surface.

6-Rotate clamp bracket 90° and make sure it is parallel with fixture frame.
Hold clamp bracket with plastic screw using a plier and so it go through fixture frame. Rotate 90° and put in the plate bracket slot.

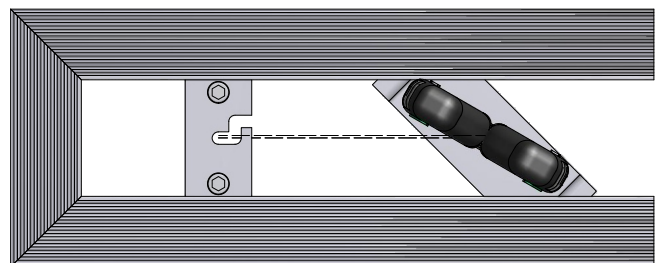
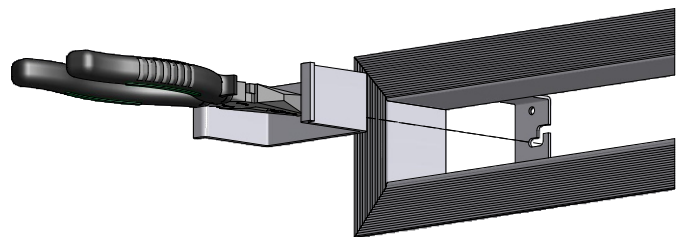
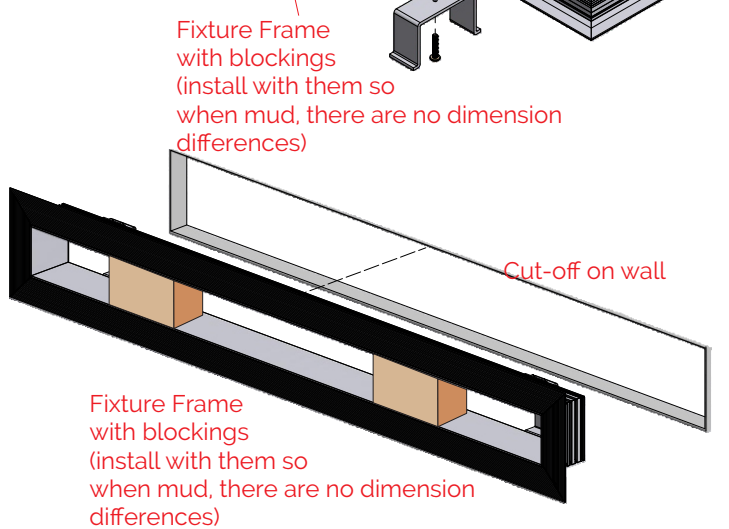
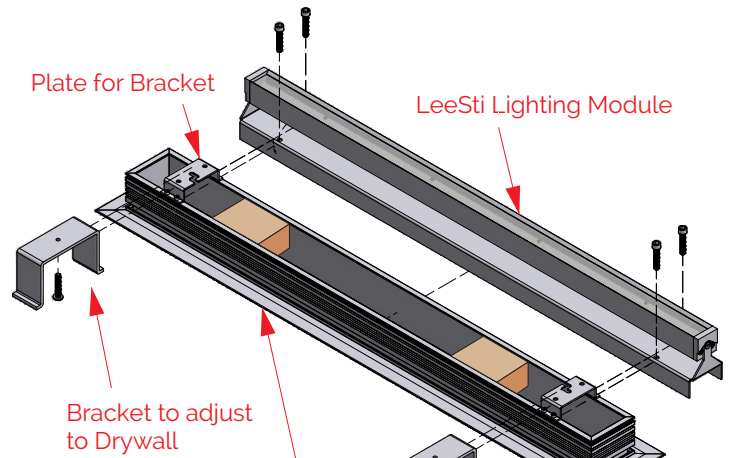

LeeSti Adjustable Trimless Wall MRI

LeeSti Adjustable Wall Recessed Trimless LED

7-Tighten clamp bracket screw until it has secured frame in wall opening. (do not over-tighten bracket as it may become damaged).

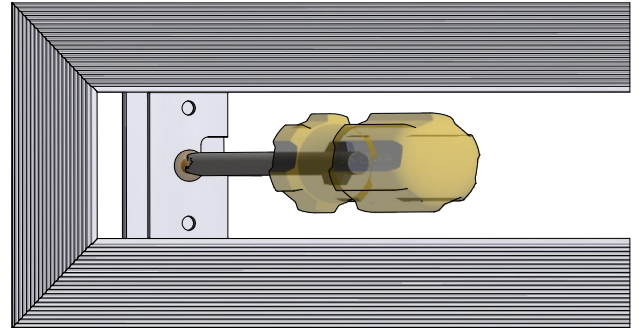

8- Use skin coat around trimless edges of frame. Extract blocking once is finish. Extrusion has a bump as guide for mud (not to go over internal part of frame)



9-Connect led module to driver output cable through fixture frame.

10. Insert led module into frame completely and fasten with socket head plastic screws.

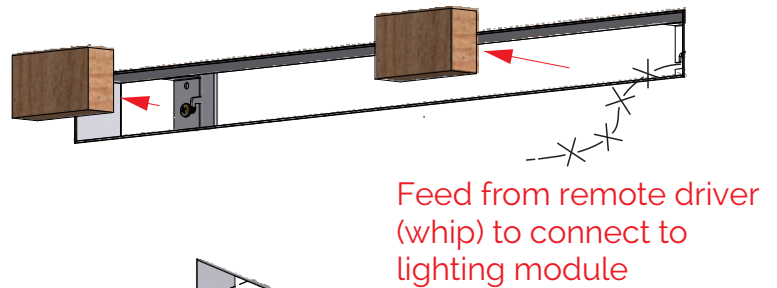

11-Restore main power to lightning circuit.

